

**CITY OF CRAIG
COUNCIL AGENDA
NOVEMBER 18, 2021
COUNCIL CHAMBERS 6:30 PM**

ROLL CALL

Mayor Tim O'Connor, Hannah Bazinet, Jim See, Julie McDonald, Michael Kampnich, Chanel McKinley, Millie Schoonover

CONSENT AGENDA

Items listed below will be enacted by one motion. If separate discussion is desired on an item, that item may be removed and placed on the regular meeting agenda.

HEARING FROM THE PUBLIC

- Open for public comment
- Resolution 21-20, Authorizing Signatories for Accounts Held at First Bank
- Resolution 21-21, Alaska Dreamin, LLC- POWI Golf Two Year Access Permit

READING OF CORRESPONDENCE

- October 29, 2021, Southeast Senior Services Thank You Letter
- November 8, 2021, Bipartisan Infrastructure Bill Status Report Letter
- November 11, 2021, USFS Update on Wolf Management

CONSIDERATION OF RESOLUTIONS AND ORDINANCES

- Resolution 21-20, Authorizing Signatories for Accounts Held at First Bank
- Resolution 21-21, Alaska Dreamin, LLC-POWI Golf Two Year Access Permit

UNFINISHED BUSINESS

- Consideration of ANCSA Landless Letter
- ATV/UTV Committee Appointment Discussion
- Consideration of Adopted Redistricting Map
- US Army Corps of Engineers and Craig Tribal Association Consultation Update

NEW BUSINESS

- American Rescue Plan Act-Coronavirus Local Fiscal Recovery Fund Amendment
- Craig Cannery Site and Harbor Concept Drawing
- Appropriation for Drainage Repairs at 1.3 mile, PSN Road
- December 2021 Council Meeting Dates

COUNCIL COMMENTS

ADJOURNMENT

To provide public comment to the council remotely, submit written comments or contact the Craig City Clerk at cityclerk@craigak.com or by calling 826-3275, before 5:00 p.m. by the day of the council meeting. City council meetings may be viewed at:
<https://www.youtube.com/channel/UCTou8Pn03MIEjLLb9Em0Xrg>.



Southeast Senior Services

A Division of Catholic Community Service, Inc.

RECEIVED
NOV 03 2021



Helping elders in Southeast Alaska stay healthy, safe and independent

October 29, 2021

Mr. Jon Bolling
City Administrator
City of Craig
PO Box 725
Craig, AK 99921

Dear Mr. Bolling:

We want to thank the City of Craig for its generous support of our Craig/Klawock Senior Center. We are pleased to report the following services provided by our Craig/Klawock Senior Center staff in the first quarter of the Fiscal Year 2022:

- * 74 senior citizens received 3,704 home-delivered meals.
- * 58 senior citizens received 1,331 rides.

During the first quarter the Craig/Klawock Senior Center remained closed due to COVID-19. All elders were able to receive home-delivered meals during this time.

Please contact me at (907)463-6154 or Marianne.mills@ccsjuneau.org if you would like additional information.

Sincerely,

Melissa Showers

Melissa Showers
Case Management Regional Coordinator

MS/acb



1803 Glacier Highway, Juneau, AK 99801 • Telephone: (907) 463-6177 • Fax: 888-756-6664

Find us on www.facebook.com/CatholicCommunityServiceInc • www.ccsak.org

RETURN TO TOP

ROBERTSON, MONAGLE AND EASTAUGH PC
A Professional Corporation

Attorneys At Law
1810 Alexander Bell Dr.
Reston, VA 20191
(571) 313-1792 office
(703) 587-7792 cell

Status Report for the City of Craig
November 8, 2021

As about everybody knows, the Congress passed the Bipartisan Infrastructure bill by the House approving it on Friday. All three members of the Alaska Congressional Delegation voted for the bill. Congressman Don Young was one of the 13 Republican House members to vote in favor of the bill to assure its passage. See a link to his statement on the bill this statement on the bill here.

<https://www.adn.com/politics/2021/11/06/statement-by-alaska-rep-don-young-on-why-he-voted-for-the-infrastructure-bill/>

For Craig, the bill may contain the remaining funding needed for the City harbor project. It is critical that the City continue to work closely with the State DOT and the Corps of Engineers on this project.

Details on how the funding will be distributed are still being developed. But the State of Alaska will receive much of this funding and will provide funding for many Alaska projects.

The bill includes the following Alaska specific provisions:

Specifically for Alaska the bill includes:

\$3.5 billion for Alaska federal highway funding

\$1.0 billion for Alaska ferry services to rural Alaskan communities

\$ 250 million for remote and subsistence harbor construction of which Alaska can be a primary beneficiary.

\$ 73 million for new ferry construction for Alaska

\$ 75 million for the Denali Commission

AMHS will be eligible for future federal Highway aid funds for operation and repair

The bill also includes the following basic provisions

Details of the bill

\$110 billion, for roads and bridges.
\$ 65 billion for broadband investments
\$ 55 billion for water systems and infrastructure
\$ 39 billion for public transit
\$ 25 billion for airports
\$21 billion for environmental remediation projects
\$17 billion for ports and waterways

\$11 billion for road safety
\$73 billion for electric grid and power infrastructure
\$66 billion for passenger and freight rail
\$50 billion for Western water storage
\$15 billion for electric vehicles.

This is the basic summary of the bill's provisions. I will provide more information as the details of the bill are provided.

[Site Map](#)[Tongass National Forest](#)[Home](#)[Special Places](#)[Recreation](#)[Alerts & Notices](#)[Passes & Permits](#)[Maps & Publications](#)[Land & Resources
Management](#)[Learning Center](#)[Working Together](#)[About the Forest](#)[News & Events](#)[Contact Information](#)**Tongass National Forest**648 Mission Street
Federal Building
Ketchikan, AK 99901-6591**Phone:** 907-225-3101
TTY: 907-228-6222
Fax: 907-228-6215[Stay Connected](#)[Contact Us](#)[2021 GMU 2 Wolf Season Announced](#)

Release Date: Nov 10, 2021

Contact(s): [Tom Schumacher](#), [Sandra Moore](#)

CRAIG, Alaska—Biologists with the Alaska Department of Fish and Game (ADF&G), in cooperation with the U.S. Forest Service (USFS), will close the state and Federal hunting and trapping seasons for wolf in Game Management Unit (GMU) 2 (Unit 2 in the Federal regulations) at 11:59 p.m. on December 15, 2021. State and Federal trapping seasons will open November 15, 2021.

Background

Beginning in 2019, the wolf harvest management strategy on Prince of Wales and associated islands, collectively known as GMU 2, changed from a harvest quota calculated as a percentage of the most recent population estimate to one where season length is annually adjusted to achieve a level of harvest that will maintain the wolf population within a sustainable fall population objective range of 150–200 wolves as established by the Alaska Board of Game. ADF&G worked with the USFS, Fish and Game Advisory Committees, the Alaska Board of Game, the Federal Subsistence Regional Advisory Council, and trappers to develop this new strategy that provides trappers with the flexibility and responsibility they desired while sustainably managing harvest of this wolf population.

The current harvest management strategy is based on annual estimates of the abundance of GMU 2 wolves. Dense forest cover makes aerial surveys impractical, so ADF&G, with support from the USFS and Hydaburg Cooperative Association (HCA), estimates wolf abundance in GMU 2 using a DNA-based mark-recapture technique. In fall 2020, ADF&G collected wolf DNA samples within the same large, northern and central Prince of Wales Island study area used in 2014-2019. ADF&G again collaborated with HCA to monitor an additional study area adjacent to the southern boundary of ADF&G's study area. This collaboration effectively expands the area sampled to nearly 80% of Prince of Wales Island and over 60% of the land area of GMU 2.

Interpreting Estimates and Harvest

ADF&G estimates the fall population of wolves in GMU 2 by analyzing the number, movements, and recaptures of individual wolves identified through DNA from samples collected from hair traps and harvested wolves. For fall 2020 ADF&G estimated the GMU 2 population at 386 wolves (point estimate) with high confidence that the actual number of wolves in GMU 2 prior to the fall 2020 hunting and trapping seasons was within the 95% confidence interval range, 320 to 472 wolves. This is the most current population estimate. All estimates involve uncertainty. Therefore, we present each GMU 2 wolf population estimate as a point estimate within a range of plausible values (95% confidence interval) which describe that uncertainty. Within that range of plausible values, the point estimate is the value most likely to be correct given the data collected that year.

The fall 2020 population estimate of 386 wolves was higher than expected considering it followed a reported harvest of 164 wolves from a fall 2019 population estimated at 316 (95% CI: 250, 398) wolves. However, other information also indicates that the GMU 2 wolf population remains robust. Numbers of hair samples collected at ADF&G's hair traps and numbers of unique individual wolves identified through DNA were similar in 2019 and 2020. Rate of trapper catch (wolves harvested per week) in both years was also similar. With only 68 wolves reported harvested in 2020, ADF&G concludes that the fall 2020 population estimate is plausible and in fall 2021 the GMU 2 wolf population remains productive and resilient.

Sealing requirements

In March 2021 the Alaska Board of Game changed state regulations for sealing wolves harvested in GMU 2, and those changes will be in effect during the upcoming wolf hunting and trapping seasons. Wolves taken in GMU 2 must be sequentially numbered or marked by the hunter or trapper, the hunter or trapper must call the ADF&G Ketchikan office at 907-225-2475 within seven days of take to report the date and location of take, and all hides must be sealed within 15 days of take. These regulations were designed to provide more precise data for managers

to use when calculating population estimates.

Federally qualified users harvesting wolves on Federally managed land in Unit 2 may also seal wolves under Federal subsistence regulations. Federal regulations require wolves harvested in Unit 2 to be sealed within 30 days of the end of the season. Federal regulations do not apply to wolves harvested on municipal, private, or state lands including tidelands. Trappers sealing wolves under Federal regulations are also encouraged to provide precise information on the date and location where each individual wolf was harvested.

Fall 2021 Harvest Management

Setting harvest season length involves considering a variety of biological factors and regulatory guidance. Although ADF&G's GMU 2 wolf population estimates have always been reasonable and consistent with the DNA collected, analysis of data from 2019 and 2020 suggests earlier estimates may have been biased low. Along with incremental improvements in capturing DNA from hair samples, in 2019 and 2020 ADF&G first had access to DNA from relatively large numbers of wolves harvested within the study area during the October-December study period. That DNA collected at sealing contributed to larger datasets available for the 2019 and 2020 population estimates and in part, appears responsible for higher estimates in those years. Fewer samples from harvested wolves available for earlier estimates may have biased those estimates low.

When setting the current fall population objective (150-200 wolves) the Alaska Board of Game referenced estimates from 2014 and 2015. If those estimates were biased low, the population objective in regulation may be set too low. Investigating potential bias in GMU 2 wolf population estimates is a top priority for ADF&G, but until we know more, managers will take a conservative approach to harvest management. The 2021 state and Federal trapping seasons for wolves in GMU 2 will be one month long (31 days), opening on November 15 and closing on December 15. State and Federal GMU 2 wolf hunting seasons will also close on Dec. 15, 2021. We believe a one-month trapping season offers substantial harvest opportunity while also ensuring that harvest will remain sustainable. We understand that GMU 2 hunters and trappers would prefer greater opportunity but considering the recent uncertainty about early population estimates and their influence on the current population objective, we believe a conservative approach is warranted.

###

USDA is an equal opportunity provider, employer, and lender.

**CITY OF CRAIG
MEMORANDUM**

To: Craig City Council
From: Sheri Purser, Treasurer
Date: November 3, 2021
RE: Resolution 21-20

Attached you will find City of Craig Resolution 21-20. The resolution changes the authorized signatories on the First Bank accounts that the City of Craig currently holds.

The requested changes to the First Bank Signatories are due to the prior City Administrator Jon Bolling resigning and the new City Administrator Brian Templin accepting the new position and adding the City Clerk Tracey Jensen to all First Bank Accounts.

Recommendation

Adopt Resolution 21-20, Authorizing the signatories on the city accounts held at First Bank.

**CITY OF CRAIG
RESOLUTION 21-20**

AUTHORIZING SIGNATORIES ON CITY ACCOUNTS HELD AT FIRST BANK

WHEREAS, the City of Craig maintains multiple accounts at First Bank; and,

WHEREAS, each account has associated with it specific authorized signers: and,

WHEREAS, the list of authorized signers for each account requires periodic updating.

NOW, THEREFORE, BE IT RESOLVED that the City of Craig hereby directs the following changes be made to the list of authorized account signers:

1. Remove Jon Bolling from all accounts.
2. Add Brian Templin to all accounts.
3. Add Tracey Jensen to selected accounts.

Adopted this ____ day of _____, 2021.

Mayor Timothy O'Connor

ATTEST _____
Tracey Jensen, City Clerk

**CITY OF CRAIG
MEMORANDUM**

To: Mayor and Craig City Council
From: City Administrator Brian Templin
Date: November 10, 2021
RE: Resolution 21-21, 24 Month Access Permit for Doug Ward dba POWI Golf

At the November 4, 2021 council meeting the council considered a request from Doug Ward to issue a 24 month access permit for his operations of a golf driving range on Tract F, ATS 1410 near the ballparks and sewer treatment plant. At that meeting, the council directed staff to prepare the resolution authorizing the permit for council consideration.

Attached is Craig Resolution 21-21, authorizing the city administrator to execute a 24 month access permit for Doug Ward to operate the golf driving range. Also attached is a copy of the permit for the council's review.

CITY OF CRAIG RESOLUTION 21-21

A RESOLUTION TO APPROVE A 24 MONTH ACCESS PERMIT TO DOUG WARD OF ALASKA DREAMIN, LLC dba POWI GOLF TO OPERATE A GOLF DRIVING RANGE ON CITY PROPERTY

WHEREAS, Doug Ward of Alaska Dreamin, LLC dba POWI Golf has requested a 24 month, non-exclusive Access Permit for the purpose of operating a golf driving range on city owned upland and tideland at Tract F, ATS 1410; and,

WHEREAS, Craig Municipal Code 16.04.020 requires that all access permits for more than one year must be approved by resolution by the City Council.

NOW, THEREFORE, BE IT RESOLVED that the City of Craig hereby directs city staff to negotiate an access permit, not to exceed 24 months, for the purpose operating a golf driving range on a portion of Tract F, ATS 1410.

Adopted this 18th day of November, 2021.

Mayor Tim O'Connor

ATTEST _____
Tracey Jensen, City Clerk

CITY OF CRAIG ACCESS PERMIT

The City of Craig (hereafter "city"), per section 16.04.020 of the Craig Municipal Code, hereby grants an access permit to Mr. Doug Ward of Alaska Dreamin, LLC dba POWI Golf, whose address is PO Box 924 Craig, AK 99921, (hereafter "permittee") for the non-exclusive use of a portion of Tract F, ATS 1410 (hereafter "the property") for use as a golf driving range, subject to the following conditions:

1. Permit Purpose. That this permit is valid for the use of the property for operation of a golf driving range. No other use may be made of the property without prior approval from the city.

2. Site Contamination Prohibited; Environmental Compliance Required. (a) Any violation, at the site of the property, by permittee, or by a third party present upon the land with permittee's permission, of an environmental statute or regulation of the city, state or federal governments shall be grounds for immediate termination of the permit by the city, at the city's sole discretion. By entering into the permit, the permittee agrees not to make any claim for monetary damages against the city for permit cancellation pursuant to this subsection.

(b) The permittee shall at all times manage permittee's activities upon the property, and the activities of third parties present with permittee's permission, so as to positively prevent any and all contamination of the property which would violate any statute or regulation, which could subject the city to enforcement action by a state or federal agency, or which could subject the city to statutory or common law liability, diminish the value of the land, or cause city expenditures for response costs caused by a hazardous substances release.

(c) By entering into the permit, the permittee agrees to defend and indemnify the city from and against any and all claims by third parties (including governmental entities and industry pollution-based claims) brought against city by reason of activities on the property during the effective period of the permit.

(d) By entering into the permit, the permittee agrees to reimburse the city for any and all expenses reasonably incurred by the city (including any response or site cleanup costs) because of activities on the property during the effective period of the permit.

3. Site Cleanup. Permittee agrees that she is individually responsible for removing all waste products and other items placed by them, or resulting from their activities, from the property. Removal will be completed no later than sixty days after the expiration of this permit, or 60 days of notice by the city that the permit is being terminated as described in item 4 below. All fixtures and equipment of whatsoever nature, that permittee shall have installed upon the property, whether permanently affixed or otherwise, shall continue to be the property of the permittee and may be removed by them

at the expiration or termination of this permit or of any renewal thereof; and at their own expense, permittee shall repair any injury to the property resulting from such removal. Such disposal must be done in compliance with State of Alaska and local regulations, and as directed by city staff. Failure to do so will subject permittee to expenses incurred by City as disclosed in item 2(d) above.

4. Permit Termination. This permit may be terminated by either party at any time, for any reason. Notice of termination will be in writing by US Mail, by electronic mail, or by hand service of the notice. The permit will be terminated not later than 10 days from the receipt of notice. This permit will also be terminated if permittee violates or fails to maintain any condition of this permit; or if payment is not made as prescribed in section 9 of this permit. No refund is due to permittee if this permit is terminated prior to the expiration date.
5. Hold Harmless. Permittee agrees to hold harmless, indemnify and defend city against any and all claims for damage, injury, or wrongful death which may be brought or asserted by Permittee, its agents, or third parties resulting from Permittee's use or occupancy of the property. Permittee will acquire general liability insurance with the city named as an additional insured, and provide the city with proof of insurance.
6. Site Management. Permittee agrees to maintain the permittee's use area and storage area in clean and good condition, and in compliance with the 15-page document "Access Permit Application", prepared by permittee and attached hereto. Permittee further agrees to install a pedestrian-activated flag notification apparatus to advise golfers to stop their activities when members of the public are present on the property.
7. Non-Exclusive Use of Site. Permittee acknowledges that the property is used by the general public. City reserves the right to use the remainder of the property and allow third party use of the remainder of the property.
8. Access, Parking and Interference. Permittee will access the property, park vehicles and conduct activities in a manner which shall not interfere with clear access to the remainder of the property by the city, leaseholders, permit holders or other parties authorized by the city.
9. Utilities. Services provided under this permit do not include utility services. Permittee must secure at its own cost any utility service it needs at the property, including but not limited to solid waste collection, water, and electric utilities.
10. Payment. In consideration for this permit, permittee agrees to pay to the city \$250.00. Payment is due upon permittee's signature to this permit.
11. Compliance with Directions from City Administrator. Permittee will comply with all directives as to the property issued by the Craig City Administrator.

12. Effective Date & Expiration Date. The effective date of this permit is February 1, 2022. This permit expires January 31, 2024, unless sooner terminated by City or permittee.

13. Authority. This permit has been issued pursuant to Craig Municipal Code 16.04.020 and City of Craig Resolution 21-21, approved November 18, 2021.

Approved this _____ day of _____, 2021.

Brian Templin, Craig City Administrator

Permittee's Acknowledgment:

I accept the conditions of this Access Permit.

Doug Ward, Alaska Dreamin, LLC

Date

**CITY OF CRAIG
MEMORANDUM**

To: Mayor and Craig City Council
From: City Administrator Brian Templin
Date: November 11, 2021
RE: Draft Letter to Senator Lisa Murkowski RE: Ketchikan Landless Land Selection

At the November 4, 2021 council meeting Jon provided a copy of an email and updated map showing newly proposed land selections for the Ketchikan landless group. At that meeting the council reiterated its position that the city does not want to see any land selections from POW and asked staff to draft a letter with that comment.

Attached is a draft letter based on council direction. Much of the letter copies comments and suggestions made in November 2020 during formal commenting on S 4889. The explicit request to not approve land selections on POW is included in the new letter.

Recommendation:

Review the letter and give staff direction as to any changes.

Recommended Motion:

Move to direct staff to submit council comments on the landless group land selection.



November 19, 2021

Senator Lisa Murkowski
United States Senate
Washington, DC 20510

Dear Senator Murkowski:

The City of Craig recently received an updated map dated 10/18/2021 from your staff showing proposed landless selections (marked on the maps as “Other Lands of Interest” for the Ketchikan Landless Corporation. This map continues to show land selections on Prince of Wales Island (Kitkun Cove).

The City of Craig is thankful for your consideration and the potential removal of some of the land selections on Prince of Wales but renews its objection to land selections on Prince of Wales Island. In our November 14, 2020 letter commenting on S4889 the city stated several objections, comments, and suggestions, including:

1. The City of Craig objects to proposed Prince of Wales land selections (including islands to the west of Prince of Wales). The city finds it difficult to believe that suitable selections of land are not available to the proposed Ketchikan and Wrangell corporations at locations closer to those communities. A review of national forest land patterns shows hundreds of thousands of acres of national forest land in and near the proposed corporation home communities. Given that ANCSA land selections are meant to benefit community shareholders, the land selections are most properly made close to the community where the corporation is based.
2. When land is selected or exchanged out of the national forest system to a recipient such as an ANCSA corporation, the subject land loses its status under Title VIII of ANILCA. That change reduces the amount of land on POW managed for rural subsistence uses, and potentially also loss of the use of public roads, landings, and other features now available to subsistence users. While the city is aware that the legislation provides for continued noncommercial uses of the selected lands in Unit 2, the bill explicitly permits the denial of access to selected lands at the will of the recipient corporation subject to broadly worded justification.
3. Prior conveyances away from the national forest have not included easements sufficient to assure continued access to longstanding recreation and subsistence sites, including access to rivers, lakes, campsites, trails, and other areas used by the public.

4. Unit 2 has been the focus of several new and large land selections over the past five years, most notably selections made by Sealaska and the Alaska Mental Health Trust Authority. These selections have made federal land management decisions on the island difficult due to the changing ownership patterns on the forest. The volume of additional land selections in the POW area resulting from S 4889 concerns the city.

The City of Craig asks that you to remove Prince of Wales Island selections from this draft map and future versions of land selection maps throughout this process.

Thank you for considering the city's comments.

Sincerely,

Mayor Tim O'Connor
City of Craig

CITY OF CRAIG MEMORANDUM

To: Mayor and Craig City Council
From: City Administrator Brian Templin
Date: November 10, 2021
RE: ATV/UTV Committee Discussion

At the November 4, 2021 council meeting the council discussed the new ATV/UTV rules recently passed by the state that allows for ATV/UTV use on roads with speed limits of 45 mph or less.

The council spent some time discussing the issue and determined that a committee should be established to continue the discussion and bring comments and/or recommendations back to the council for further consideration. There were several members of the public at the meeting who volunteered to be on the committee (both Craig residents and Port St. Nicholas Road residents).

Craig Municipal Code 2.07 covers the formation of advisory committees. Advisory committees are formed by resolution, have limited council participation (one non-voting member), and are restricted to city residents. After discussing the committee concept with the mayor staff proposes that we put together an informal working group for the purpose of generally discussing the issues and providing for additional opportunities for the public to participate in these discussions. The working group should be made up of:

- Mayor
- One or more council members
- Police Chief
- EMS Coordinator
- Administrator
- 3 – 5 public volunteers

The working group should set some schedule between now and mid December to host some meetings to discuss the issue for the purpose of staff bringing comments and recommendations back to the council for consideration of the issue. The working group would have no additional authorities or responsibilities related to the issue and the council would have final decision making authority on the ATV/UTV issue. The schedule will be set so that the council will have time to adopt a policy prior to the state regulations taking effect on January 1, 2022.

Recommendation

Move to authorize staff to solicit public interest and work with the mayor to put the working group together to solicit comments and suggestions regarding ATV/UTV use on city streets.

CITY OF CRAIG MEMORANDUM

To: Mayor and Craig City Council
From: City Administrator Brian Templin
Date: November 10, 2021
RE: Adopted Redistricting Maps and Proclamation

As the council is aware, the Alaska Redistricting Board has been considering new house and senate district maps based on the 2020 Census data. The council has discussed the draft maps at recent meetings. On November 9th the Redistricting Board adopted its final redistricting map and on November 10th the board adopted a proclamation laying out the election cycles for state senators.

Craig is in the district identified as House District 2A. This district runs from Prince of Wales to Yakutat and includes Sitka and Petersburg. All communities on Prince of Wales except Whale Pass and Coffman Cove are in District 2A. We will share a state senator with District 1A which includes the Ketchikan, Wrangell, Whale Pass, Coffman Cove, Saxman, and Metlakatla areas.

State House representatives serve two year terms and are up for election on even numbered years. State senators serve four year terms and generally half of the senate is up for election each even numbered year. When redistricting happens the redistricting board identifies the senators up for election in the next cycle. In 2022 our house representation is up for election under the normal course of terms and our senate district is up for election based on the redistricting board's proclamation.

Now that the final map and proclamation have been adopted it is likely that there will be some challenges to the final map in the courts. Staff will continue to track this issue if it is litigated and will follow up with the council if the litigation affects the Craig/Prince of Wales area.

The final adopted map for Southeast and the proclamation are attached.



2021 Board Proclamation Southeast

Redistricting Plan Adopted by the Alaska Redistricting Board 11/10/2021

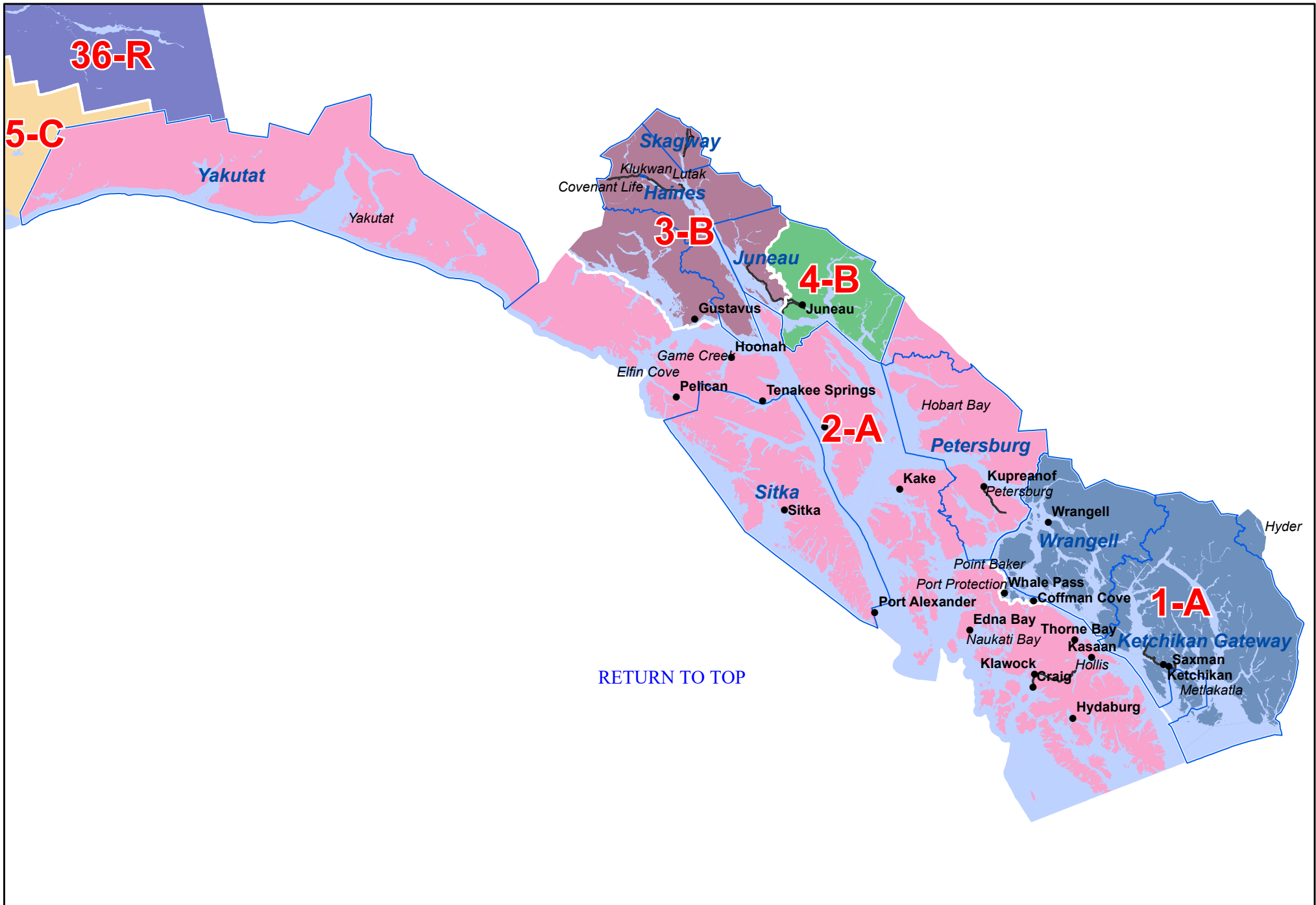

[RETURN TO TOP](#)



ALASKA REDISTRICTING BOARD

PROCLAMATION OF REDISTRICTING

WHEREAS, Article VI of the Alaska Constitution requires the Alaska Redistricting Board to reapportion the House of Representatives and the Senate immediately following the official reporting of each decennial census of the United States; and

WHEREAS, the United States Bureau of the Census conducted a census of the United States on April 1, 2020 and reported the results of the census to the State of Alaska on August 12, 2021; and

WHEREAS, the Alaska Redistricting Board was duly constituted in August 2020 and undertook its constitutional responsibilities for preparing a redistricting plan for the State of Alaska; and

WHEREAS, the Alaska Redistricting Board adopted draft redistricting plans on September 9, 2021, in conformity with Article VI, section 10 of the Alaska Constitution, requiring that the Board adopt a draft plan or plans within 30 days of the reporting of the Census results for Alaska; and

WHEREAS, the Alaska Redistricting Board held numerous public hearings throughout the state in conformity with Article VI, section 10 of the Alaska Constitution; and

WHEREAS, the Alaska Redistricting Board strictly adhered to the requirements of Article VI, Section 6 of the Alaska Constitution and the "Hickel process" outlined by the Alaska Supreme Court to draw districts consisting of contiguous and compact territory containing as nearly as practicable relatively integrated socio-economic areas and a population as near as practicable to 18,335; and

WHEREAS, adhering to Article VI, Section 3 of the Alaska Constitution, the Board did not adjust, alter or modify the Census enumerated population or Census block geography; and

WHEREAS, the Alaska Redistricting Board adopted by this Final Plan and Proclamation of Redistricting today, November 10, 2021 in conformity with the constitutional requirement that it do so within 90 days of the reporting of the Census results for Alaska.

NOW, THEREFORE, THE ALASKA REDISTRICTING BOARD, hereby does PROCLAIM, ON THIS DAY NOVEMBER 10, 2021

First, that the state house election districts described in this Redistricting Proclamation and in the report accompanying this Redistricting Proclamation, shall be implemented for legislative elections in the year 2022, and thereafter, until a valid Redistricting Proclamation has been adopted following the next decennial census; and

Second, that the terms of Senate incumbents – B, D, F, H, J, and N under the 2013 Redistricting Proclamation labeling system be truncated because those Senate Districts have been substantially changed by this Redistricting Proclamation, and that the term of the incumbent of Senate District T, not be truncated because that Senate District is substantially unchanged; and

Third, that Senate districts be assigned to election cycles according to the following schedule, using the 2021 Senate District designations in this Redistricting Proclamation:

Elected in 2022, 2026, 2030

A
C
E
G
I
K
M
O
Q
S

Elected in 2024, 2028, 2032

B
D
F
H
J
L
N
P
R
T

Fourth, that the metes and bounds district descriptions appended to this Redistricting Proclamation may be used to resolve inconsistencies between district boundaries and topographic features.

Dated this 10th day of November, 2021 at Anchorage Alaska.

In support:



John Binkley of Fairbanks, Chair

Bethany Marcum, of Anchorage

E. Budd Simpson, of Juneau

In opposition:

Melanie Bahnke, of Nome

Nicole Borrromeo, of Anchorage

CITY OF CRAIG MEMORANDUM

To: Mayor and Craig City Council
From: City Administrator Brian Templin
Date: November 10, 2021
RE: US Army Corps of Engineers and Craig Tribal Consultation

The November 4, 2021 council meeting packet included a copy of a letter from the Craig Tribal Association (CTA) to the US Army Corps of Engineers (USACE) requesting government to government consultation on the Craig Cannery Site Project.

The CTA specifically pointed out to the USACE that CTA felt it had not been adequately consulted on the project to date. CTA voiced concerns about the cultural and historic importance of the site to the Craig Tribe and other tribal communities and that the project is within an area that continues to be used for subsistence harvesting of early King Salmon.

The USACE met with CTA on Monday, November 8th. Based on current guidance that the USACE operates under, the City of Craig was not party to the discussions on the 8th. On Tuesday, November 9th I met with members of the USACE staff to discuss the consultation and the next steps.

The USACE shared with me that the discussion with CTA focused on a series of issues, including:

- The tribe requested better overall communications with the USACE and city on the project.
- The tribe voiced concerns about the canoe haul outs at the site. The USACE shared that the tribe felt that the canoe haul outs were damaged or displaced during work done by the city on the site.
- The tribe voiced concerns about the Chinook fishery in the area being affected (under the USACE guidance, the USACE classifies subsistence activities as cultural resources).
- The tribe voiced concerns about the handling of potential cultural resources recovered at the site during earth disturbing work on the project.

As part of the consultation process the USACE has notified the CTA that they will work to involve the tribe more fully in the project moving forward.

The next step in the process is for the USACE to set up staff level meetings between the CTA and the city to discuss the tribe's concerns. It is likely that the first of these meetings will be scheduled for the week of November 15th or the week of November 22nd. I will attend these meetings on the city's behalf and will keep the mayor informed of the meeting schedule to allow for his participation as well.

I will keep the council updated as these meetings progress and will involve the mayor and council in any decisions related to this consultation.

CITY OF CRAIG MEMORANDUM

To: Craig City Council
From: Brian Templin, City Administrator
Date: November 10, 2021
RE: Amendment to ARPA Agreement and Use of ARPA Funds

As the council will recall, earlier this year Congress passed and the President signed the American Rescue Plan Act of 2021 (ARPA). ARPA is the latest in a series of federal legislation providing funding in response to COVID-19. Based on estimates that were published earlier this year the city expected to get about \$600,000 total from two pots of funds. One part of the program calculated payments to communities directly and the other program that we are eligible for provided funds for areas in Alaska outside of organized boroughs (in our case it was the POW-Hyder Census Area). The city has already received \$152,318,51 from the funds directed to cities. We expect to receive another \$152,000 from this program sometime next calendar year. We were recently informed that the City of Craig's share of the money designated for the census area is \$401,520. This is about \$100,000 more than the initial calculations projected. The state is prepared to issue payment for the first half of this funding immediately upon signing an amendment to the grant agreement with the state. The other half of these funds will be sent out sometime next calendar year based on the federal guidance and information from the state.

In August, the council had an initial discussion on use of the funds. As a reminder, broadly speaking, ARPA funds due to the city may be used:

- a) To respond to the public health emergency or its negative economic impacts, including assistance to households, small businesses, and nonprofits, or aid to impacted industries such as tourism, travel, and hospitality;
- b) To respond to workers performing essential work during the COVID-19 public health emergency by providing premium pay to eligible workers;
- c) For the provision of government services to the extent of the reduction in revenue due to the COVID-19 public health emergency relative to revenues collected in the most recent full fiscal year prior to the emergency; and
- d) To make necessary investments in water, sewer, or broadband infrastructure.

Many of the permitted uses of ARPA funds closely match rules governing use of CARES Act funds, including programs for direct payments to households/individuals, grants to businesses, and support for rent, mortgage, child care, and utility costs. Under ARPA many of the financial assistance programs the city offered to individuals and businesses last year are now available through the State of Alaska.

One notable difference in ARPA compared to the CARES Act is the option for cities like Craig to offset wages of police, EMS, fire department, and other staff; that use of funds is still allowed, but ARPA uses a much more narrowly defined method to determine payroll eligibility than the CARES Act. If the city chooses to draw on eventual ARPA funding for eligible wages, the amount will be a small fraction of what was drawn for wages under CARES.

ARPA does provide for local governments to use funds from the law to reimburse for loss of revenue due to impacts from the COVID-19 pandemic, based on a formula provided in the guidance issued by the US Treasury Department. An initial calculation prepared by staff estimates that Craig may be able to claim about \$142,000 in lost revenue. If claimed, the \$142,000 could be deposited into the city's General Fund to finance general government services. The city's current fiscal year budget anticipates \$100,000 in revenue from COVID-related sources.

ARPA also provides that cities like Craig can use funding for general water, sewer, and broadband infrastructure. These projects are identified as permitted outright by the federal guidance. The city has several water and sewer needs that could benefit from the ARPA funding, including:

- Wastewater Treatment Plant Roof. The city's wastewater treatment plant needs a new roof. The existing roof has degraded over the past twenty-five years, due in no small part to the treatment processes that occur in the building. A rough estimate from a contractor to replace the roof totaled about \$300,000.
- Wastewater Pump Stations. The city has three, 40-year old wastewater pump stations that merit replacement: downtown near JT Browns Store, on the Craig Fisheries property, and on Easy Street. Depending upon the replacement design, any one of these pump station projects could exhaust the available ARPA funding.
- Water Treatment Plant Upgrades. City staff have considered for a year now how to best go about hiring an engineering company to provide recommendations on increasing production of treated water from the city's water treatment plant at PSN using the existing equipment in the building. The Alaska Native Tribal Health Consortium recently agreed to refund \$75,000 the city sent the consortium to fund the effort. Despite the delay in its implementation the engineering review is still a worthwhile project

At the August meeting the council approved use of some funds to supplement the Craig Child Care Center(CCCC) wages. Recently the council extended the timeline for the CCCC to use those funds. In addition, some funds have been used for PPE and other COVID19 response related items.

Now that we have been given the final funding amounts it would be helpful to staff for the council to revisit this discussion and consider some uses of the funds. All funds must be expended by December 31, 2024 or returned to the state.

Options for use of the funds include one or more of the following:

1. Distribute funding to local businesses and residents in a manner similar to CARES funding programs implemented by the city in 2020.
2. Claim eligible city payroll.
3. Claim lost revenue from ARPA receipts for use on general government services.
4. Apply the funding toward needed water and sewer infrastructure projects.

At the council meeting on November 4th the council asked about use of ARPA funds to reimburse the city for some emergency management work done at the Craig High School and

asked about the cost of renewing the medivac insurance that the city sponsored that expires this month.

The emergency management work was invoiced prior to ARPA funding and is ineligible for direct funding, but options to offset some eligible payroll or use lost revenue funding to supplement the city's general fund will create additional budgeted funds to be freed up in the current budget, which can have the same effect as reimbursing for this invoice.

I have asked AirMedCare (Guardian) to provide a quote for an additional year of medivac insurance under the same terms as this past year (households within the Craig City Limits for 12 months). This service appears to be an eligible expense as a "individual assistance" program under the guidance. They had not gotten back to me as of the writing of this memo. I will send this quote out to the council prior to the meeting on the 18th.

The state has offered a number of small business and individual assistance programs using ARPA funding at the state level. We have been actively advertising those services to local residents.

Funds will be segregated into a separate account until they are used for purposes authorized by the city.

Recommendation

The council should authorize the mayor to execute the grant amendment regarding the final dollar amount so the city can receive the first additional payment of about \$200,000. The council should direct staff to prepare final calculation to recover lost revenue but limit this draw on ARPA funds to \$100,000; prepare calculations to draw from ARPA funds to reimburse city costs for staff time eligible under ARPA; advise staff as to use of ARPA funds for water and sewer infrastructure; advise staff as to the use of ARPA funds for other projects or items of interest to the council. The direction to execute the grant amendment should be made by motion and a vote of the council. Direction as to the use of ARPA funds can be done in a general discussion and staff will bring final amounts back to the council for appropriation at a future meeting.

Recommended Motion

Move to direct staff and the mayor to execute the amendment to the ARPA Coronavirus Local Fiscal Recovery Plan Fund Agreement with the State of Alaska.

**AMERICAN RESCUE PLAN ACT (ARPA)
CORONAVIRUS LOCAL FISCAL RECOVERY FUND (CLFRF)
AMENDMENT**

Department of Commerce, Community, and Economic Development, Division of Community and Regional Affairs

Non-Units of General Local Government: (Non-UGLG) Local Gov't Name City of Craig		NEU Recipient Number: AK0028	Unique Identifier Number: AK0028-N	
CFDA: 21.027	EIN Number 92-6000139	DUNS Number 002189009	Vendor Number: CIC84492	Appropriation Unit: 085601269

Amendment # 1

EFFECTIVE THE DATE SIGNED BELOW THIS GRANT IS HEREBY AMENDED AS FOLLOWS:

1. This Coronavirus Local Fiscal Recover Fund distribution is modified to include an increase of **\$401,620.00** as reflected below:

	CLFRF to NEU	Additional CLFRF to Non-UGLG	TOTAL CLFRF Amount:
ARPA Funds:	\$304,637.01	\$401,620.00	\$706,257.01

2. The city's first payment will be half of the Coronavirus Local Fiscal Recovery Fund to Non-Units of General Local Government (Non-UGLG), this allocation will be using the Unique Identifier Number identified above.
3. By signing this amendment, the city agrees to US Department of Treasury's reporting requirements, which must include the combined funding received under the program including ARPA, NEU and Non-UGLG Coronavirus Local Fiscal Recovery Funds.

ALL OTHER TERMS AND CONDITIONS OF THE GRANT AGREEMENT REMAIN IN FULL FORCE AND EFFECT.

Non-Units of General Local Government	Department
Signature:	Signature:
Printed Name and Title of Authorized Representative: Tim O'Connor, Mayor	Printed Name and Title: Pauletta Bourne, Grants Administrator III
Date:	Date:

CITY OF CRAIG MEMORANDUM

To: Mayor and Craig City Council
From: City Administrator Brian Templin
Date: November 11, 2021
RE: Craig Cannery Site and Harbor Concept Drawings

The city recently contracted with Corvus Design In. of Juneau to prepare a number of documents related to the cannery site development. The documents include:

- Concept Drawings of the upland development
- Concept Drawings of the harbor development
- Initial Cost Estimates for harbor construction
- Historic American Building Survey (HABS) documents for a number of the higher priority buildings
- A basic condition assessment and opinion on the viability of restoration or preservation of existing structures on the site

Corvus was in Craig at the end of September and conducted several public meetings and narrowed several alternatives down to a preferred concept for the upland and harbor. The Craig Planning Commission and Craig Harbor Advisory Committee reviewed the final draft alternative and gave guidance to Corvus. Corvus completed the incorporation of those comments and submitted the final draft concept to the city for final review. The planning commission and harbor committee have reviewed the final concept and do not have any changes.

The final draft concept drawing for both the upland and the harbor are attached to this memo for council review and comment. If the council adopts the final draft concept plan Corvus will make any last changes and will resubmit the drawings to the city, along with a number of elevation drawings of the site based on the concept.

It is important to note that this drawing is still a concept and does not commit the city to land allocation, harbor design, existing buildings, or any other component. Some final decisions on these issues will have to be made separately by the council over the next few years. The council will have ample opportunity to modify the final designs of the site prior to any construction.

Corvus is continuing to work on the other documents listed above and will submit those between now and the end of the year.

Recommendation

Move to adopt the concept drawing of the Craig Cannery Site and Harbor.



City of Craig Harbor Concept Design

Cannery Site and Harbor Draft Preferred Plan

REV. 10/29/2021

[RETURN TO TOP](#)

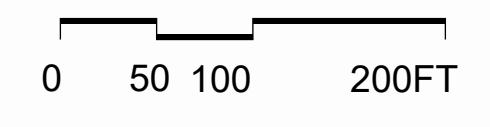

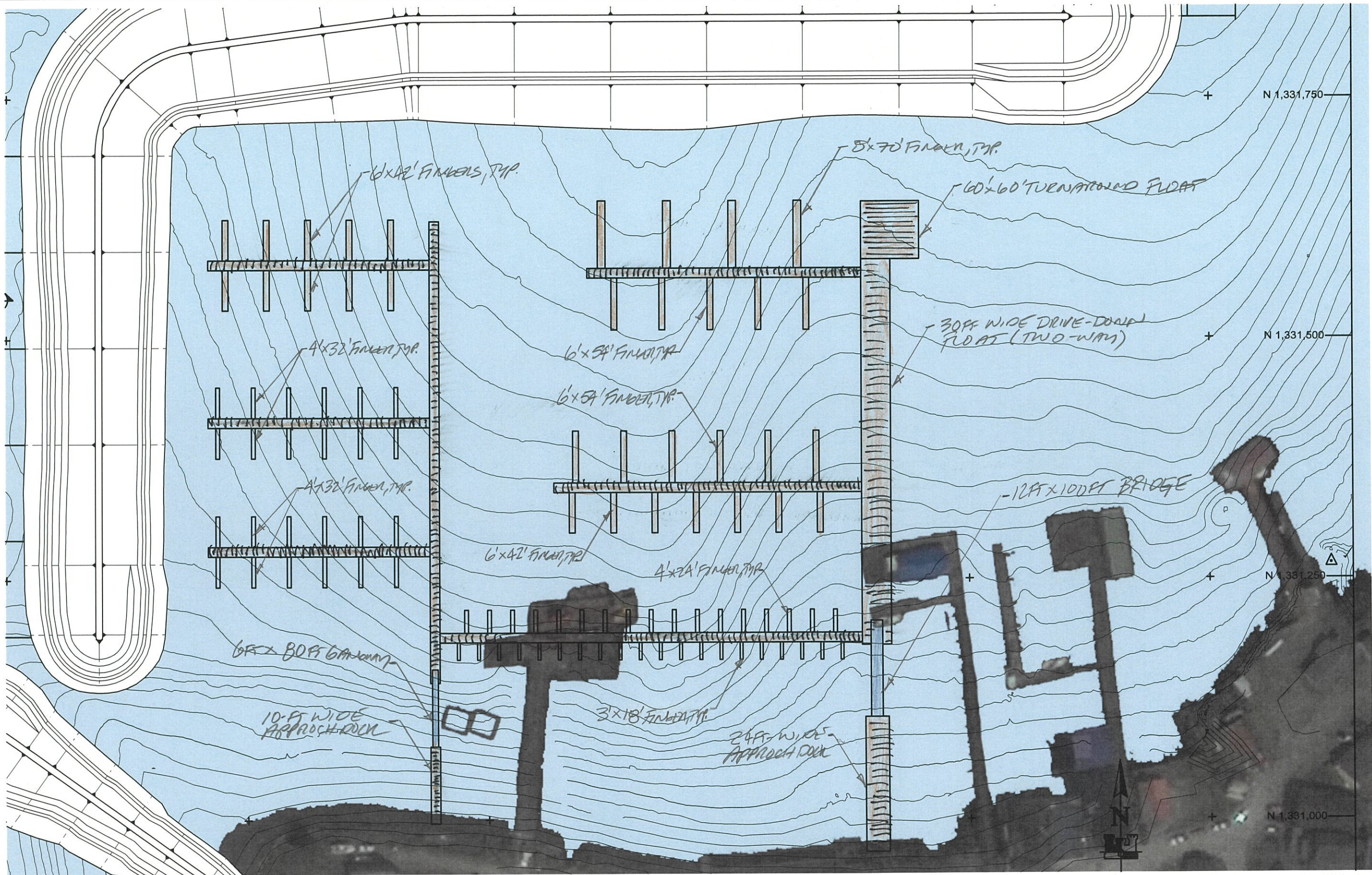

MOORAGE SUMMARY:

SLIP SIZE	FINGER FLOAT SIZE	TOTAL NO. SLIPS
OVER 60FT	8FT x 70FT	9 (+2)**
47-60FT	6FT x 54FT	24 (+3)**
37-46FT	6FT x 42FT	37 (-6)**
28-36FT	4FT x 32FT	52
21-27FT	4FT x 24FT	36
UNDER 20FT	3FT x 18FT	41
TRANSIENT	VARIABLE	1,000FT +/-

TOTAL SLIPS: 200

REVISIONS

REV.	DATE	DESCRIPTION	DWN.	CKD.	APP.

PND ENGINEERS, INC.

9360 Glacier Highway Suite 100
Juneau, Alaska 99801
Phone: 907-586-2093
Fax: 907-586-2099
www.pndengineers.com

DESIGN: _____ CHECKED: _____
DRAWN: _____ APPROVED: _____

SCALE: SCALE IN FEET
0 50 100 FT.

DATE: 10/20/21

SHEET TITLE: **CONCEPT 3A**

PND PROJECT NO: 212063 C.A.N. NO: AECC250

3 (A)

10/19/2021 7:59:27 PM

[RETURN TO TOP](#)

CITY OF CRAIG
MEMORANDUM

To: City Council
From: Russell Dill
Date: 11/11/2021
RE: Request for 1.3-mile PSN landslide mitigation funds

There is a need to complete proper drainage to the double culverts at 1.3-mile landslide area. There is a concern that seepage from the earthwork shoring that runs parallel to PSN road will undermine the pavement and cause frost heave damage to the asphalt this coming spring. The plan is to cut a ditch from the double culvert area behind the Jersey barriers directly in a straight line to intersect water flow, therefore eliminating the need for the shoring.

Public works would utilize its full crew. Public works would rent a JD210, and JD120 excavator to accomplish this work.

Estimated cost:

1. JD120 Excavator one-week rental: \$2,150.00
 2. JD210 Excavator one-week rental: \$3,015.00
 3. Mobilization: \$1,100.00
 4. Unexpected costs: \$650.00
- Total: \$6,915.00

Recommended motion:

I move to appropriate \$6,915.00 from the city's general fund to restore drainage to the double culvert as originally intended.

CITY OF CRAIG MEMORANDUM

To: Mayor O'Connor and the Craig City Council
From: Tracey Jensen, City Clerk
Date: October 28, 2021
RE: December Council Meeting Dates

It is not unusual to have just one council meeting in December due to council travel and other holiday engagement availability.

The Craig City School District music concert dates are as follows:

Elementary (K-4th) is December 9th at 6:30pm (Thursday)
Secondary (5th-12th) is December 16th at 6:30pm (Thursday)

The regular upcoming meeting dates would normally be December 2nd and December 16th this year if there were two meetings. If the council members need to attend the secondary school music concert, it is feasible to set the council meeting for Tuesday, December 14th, or Wednesday, December 15th instead.

Recommendation:

Motion to set one City Council meeting on Thursday, December 16th, 2021, at 6:30pm.