

1. Spruce Street Water Tank Site

2. East Hamilton Drive Park Site (near existing playground)

3. Tract D2, Crab Creek (current parking area across from Sunnahae Trailhead)

5. CK Highway Site (wooded strip near Healing Heart Park)

4. Aquatic Center Site (area at north end of existing building)

6. Near Burn Pit (flat area just south of city burn pit)

7. Wooded Area near Ralph James Park

Craig, Alaska Street Addresses

12/12/18

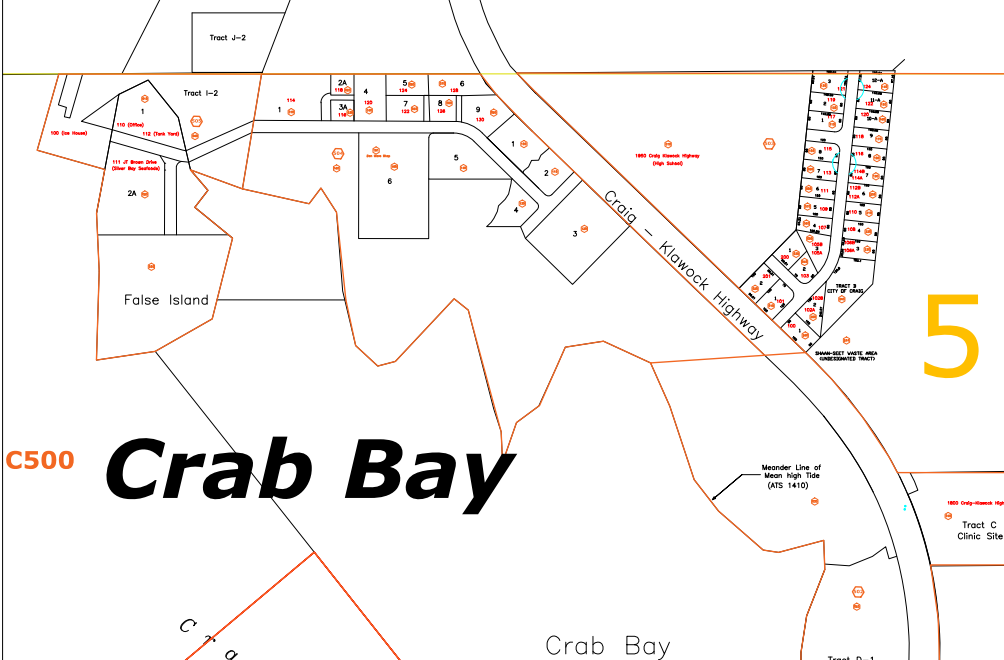

C500 **Crab Bay**

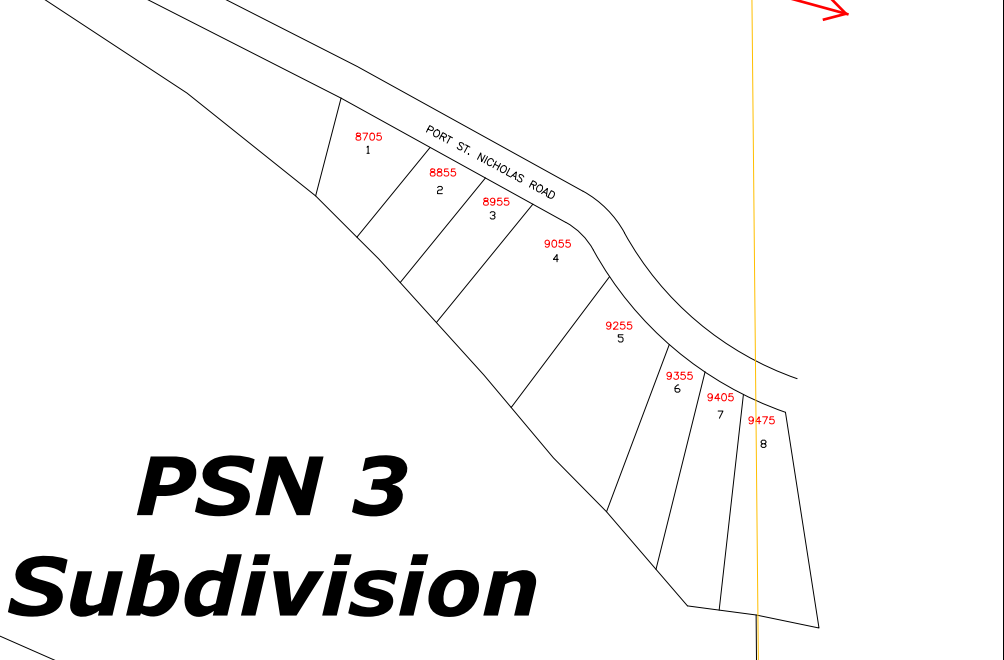

**PSN 3
Subdivision**