

BP 03-22

CITY OF CRAIG, ALASKA
BUILDING PERMIT APPLICATION

Applicant Information

Name SHAAN SEET INC.
Mailing Address P.O. Box 690
Street Address 501 MAIN ST.
City, State, Zip CRAIG, AK, 99921
Telephone 907-826-3257

Owner Information (if not also applicant)

Name EDWARD DOWVILLE
Mailing Address P.O. Box 563
Street Address PSN 3.25 LOT 808
City, State, Zip CRAIG, AK, 99921
Telephone 907-826-3257

Property Description

Subdivision Name SSI OFFICE **TR 91**
Survey Number: 1429 Tract Number: AK 15 Lot Number: ~~50 89 0693~~ Block Number:
Army Corps of Engineers Permit Name and/or Number: N/A

Building Activity Information (please check one)

- Single Family Home
- Deck
- Commercial Building
- Mobile Home (Year and Make) N/A
- Travel Trailer (Year and Make) N/A
- Other (Please describe): N/A
- Duplex
- Porch
- Wannigan
- Triplex
- Retaining Wall
- Garage
- Fourplex or greater
- Addition
- Shed

Height of Building at Roof Eave: 12' Closest setback to property line: 15'
Building Dimensions: 12' x 24' Area of building footprint: 405 sq. ft.
What use(s) do you propose for the building? ARCHIVE SHED FOR SSI RECORDS.

Site Plan

Please complete on reverse side or attached sheet a site plan showing all proposed construction.

Owner's/Applicant's Statement

I acknowledge that I have read this application and state that the above information is correct. I agree to comply with all codes and ordinances of the City of Craig applicable to building and construction, and all land use regulations as pertaining to this permit. Any violation of land management regulations are the responsibility of the property owner. This permit becomes void upon completion of the approved work, or one year, whichever comes first. Work not documented in this application is not authorized by this building permit. I understand that this permit is revocable if work is not completed consistent with this applicant or if work does not comply with the requirements of the City of Craig Municipal Code. I agree to provide the City of Craig with an as-built survey of the lot in the event one is completed for this project.

[Signature] 11-12-21 N/A
Signature of Applicant Date Signature of Property Owner (if other than applicant) Date

Special Conditions of Approval.

The following conditions of approval are made a part of this permit as provided by section 18.06.001B.6 of the Craig Land Development Code:
#1. No construction of any wall or deck/stairs within 10' of any property line without approval by the State Fire Marshal.

Permission is hereby granted to perform the above work in compliance with any and all conditions listed above and in compliance with the Craig Land Development Code and all other ordinances of the City of Craig and the State of Alaska pertaining to the construction of buildings.

[Signature] 2/11/2022
Signature of City Building Official Date

W

BP 03-22

SITE PLAN

Show the items from the checklist below in the drawing grid. The drawing must be legible and accurate.

Lot lines and dimensions

Distances from all structures to lot lines

Proposed structures with dimensions

All easements, streets, alleys, sidewalks

Existing structures and their dimensions

Parking spaces

Water lines

Sewer lines

Electric lines and poles

Driveways

North Arrow

Other pertinent information

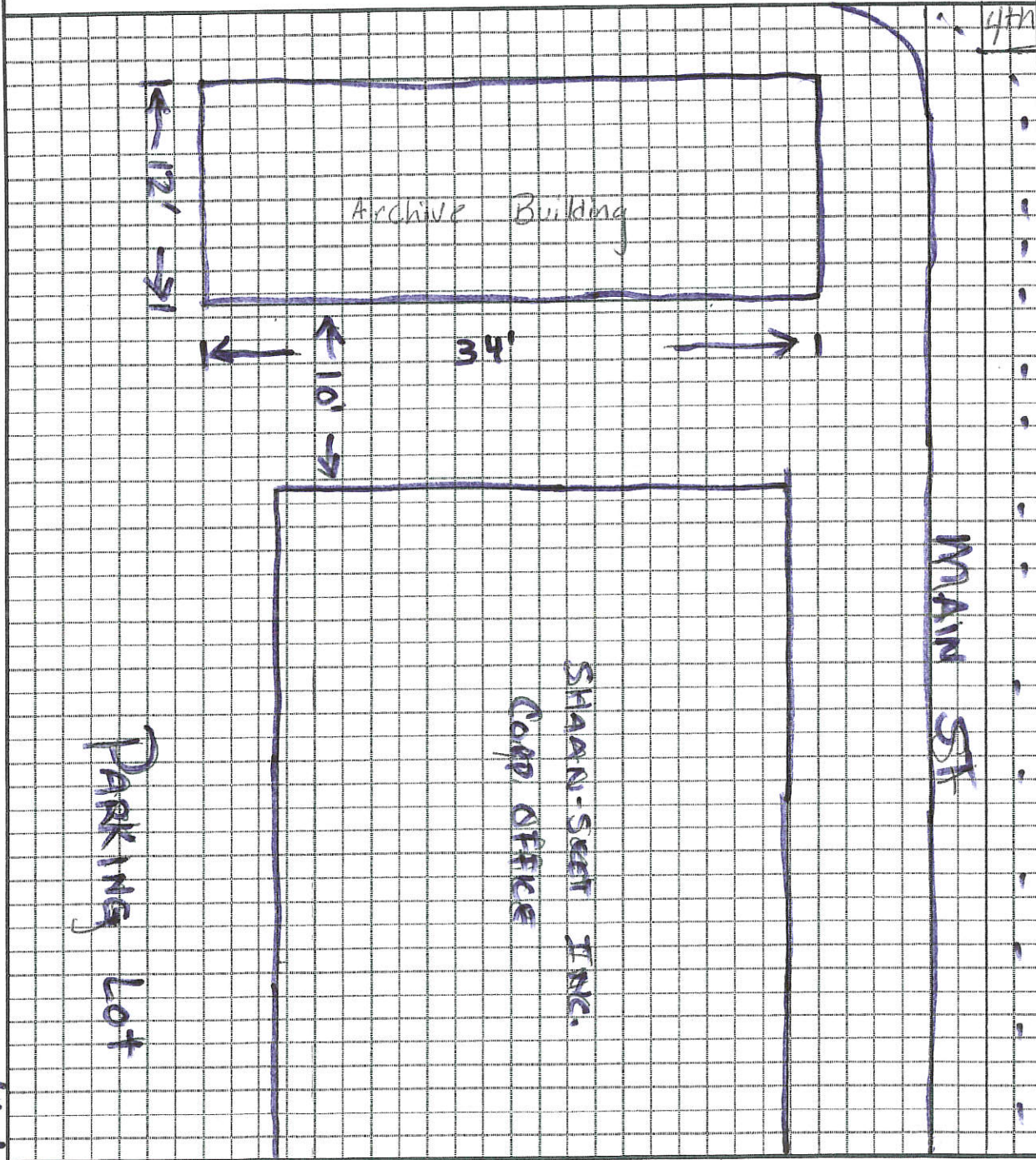

Measurements Not Accurate
For Corporation Building

E