



Building Permit

Permit No. 16-22 Date: 11/16/2023 Expires: 12/31/2024

Permittee's Name: Daniel Nelson

Building Address: Lot F2, USS 2327(440 Hamilton Drive)

QUESTIONS OR COMMENTS?
CONTACT THE CRAIG BUILDING OFFICIAL
(CRAIG CITY PLANNER) AT 907-826-3275.

Samantha A. Wilson, Craig Building Official
Building Official
POST ON BUILDING SITE

CITY OF CRAIG, ALASKA
BUILDING PERMIT APPLICATION

Applicant Information		Owner Information (if not also applicant)	
Name	DANIEL WELSAJ	Name	
Mailing Address	229	Mailing Address	
Street Address	440 WEST HAMILTON	Street Address	
City, State, Zip	CRAIG	City, State, Zip	
Telephone	360 411 7681	Telephone	

Property Description

Subdivision Name _____

Survey Number: 2327 Tract Number: F Lot Number: F2 Block Number: _____

Army Corps of Engineers Permit Name and/or Number: _____

Building Activity Information (please check one)

Single Family Home Duplex Triplex Fourplex or greater

Deck Porch Retaining Wall Addition

Commercial Building Wannigan Garage Shed

Mobile Home (Year and Make) _____

Travel Trailer (Year and Make) _____

Other (Please describe): Green House

Height of Building at Roof Eave: 9' Closest setback to property line: _____

Building Dimensions: 10'x22' Area of building footprint: _____

What use(s) do you propose for the building? GARDENING

Site Plan

Please complete on reverse side or attached sheet a site plan showing all proposed construction.

Owner's/Applicant's Statement

I acknowledge that I have read this application and state that the above information is correct. I agree to comply with all codes and ordinances of the City of Craig applicable to building and construction, and all land use regulations as pertaining to this permit. Any violation of land management regulations are the responsibility of the property owner. This permit becomes void upon completion of the approved work, or one year, whichever comes first. Work not documented in this application is not authorized by this building permit. I understand that this permit is revocable if work is not completed consistent with this applicant or if work does not comply with the requirements of the City of Craig Municipal Code. I agree to provide the City of Craig with an as-built survey of the lot in the event one is completed for this project.

Signature of Applicant: Daniel Welsaj Date: 07.10.23 Signature of Property Owner: _____ Date: 11.16.23

Special Conditions of Approval.

The following conditions of approval are made a part of this permit as provided by section 18.06.001B.6 of the Craig Land Development Code:

- 1.) Structure must not encroach into 10' property setbacks in its final location.
- 2.) Current structure will be moved outside of property setbacks to the indicated location on the site plan within 60 days. Failure to do so may result in fines.

Permission is hereby granted to perform the above work in compliance with any and all conditions listed above and in compliance with the Craig Land Development Code and all other ordinances of the City of Craig and the State of Alaska pertaining to the construction of buildings.

Signature of City Building Official: Samantha Wilson Date: 11/16/23

SITE PLAN

Show the items from the checklist below in the drawing grid. The drawing must be legible and accurate.

- | | |
|--|-----------------------------------|
| _____ Lot lines and dimensions | _____ Water lines |
| _____ Distances from all structures to lot lines | _____ Sewer lines |
| _____ Proposed structures with dimensions | _____ Electric lines and poles |
| _____ All easements, streets, alleys, sidewalks | _____ Driveways |
| _____ Existing structures and their dimensions | _____ North Arrow |
| _____ Parking spaces | _____ Other pertinent information |

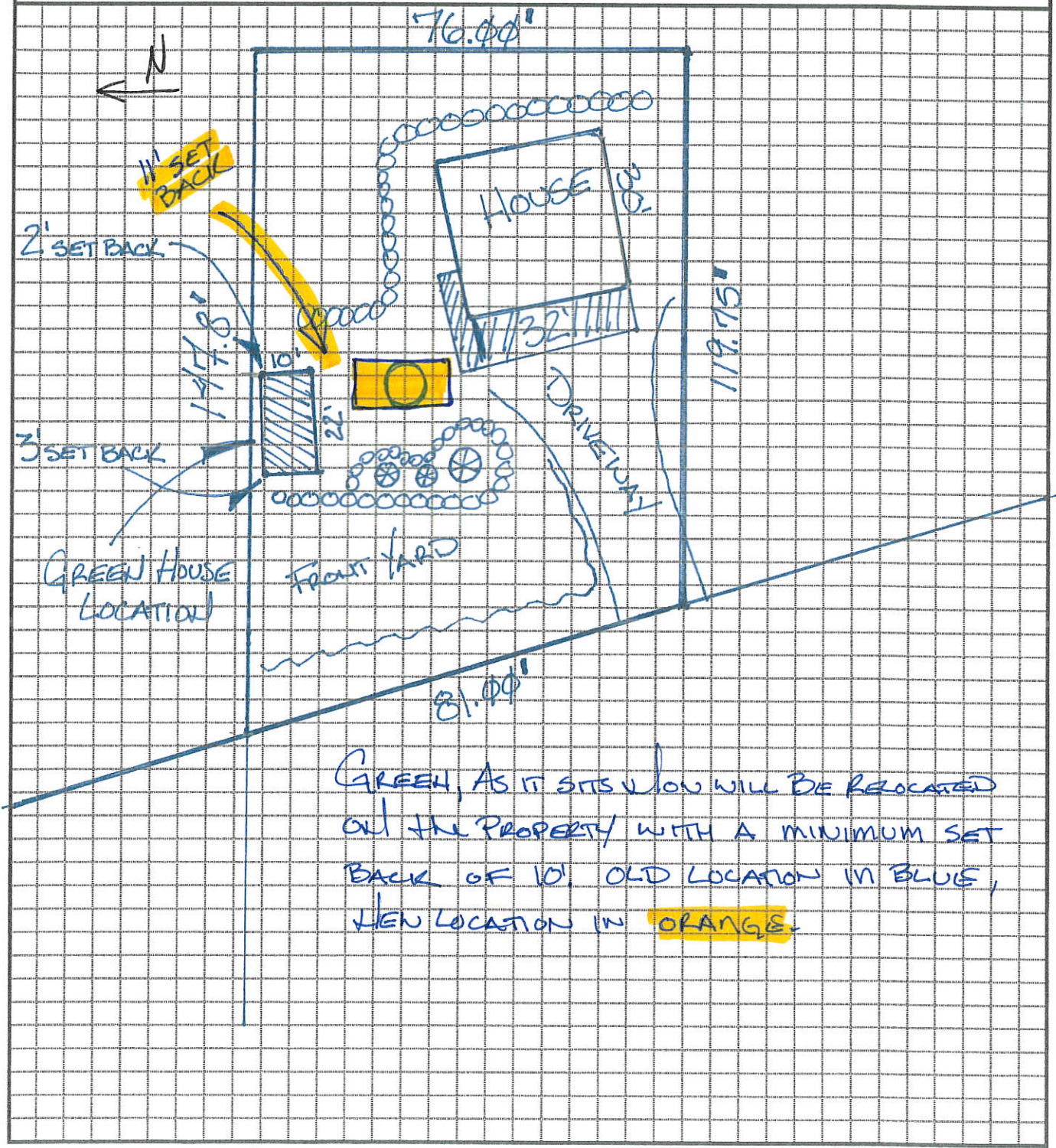

GREEN, AS IT STANDS NOW WILL BE RELOCATED ON THE PROPERTY WITH A MINIMUM SET BACK OF 10'. OLD LOCATION IN BLUE, NEW LOCATION IN ORANGE.

GREEN HOUSE IS 10' x 22'

BP-16-23

Geophysical
Data Center
7/07/2011

TRACT

S 0°00'00" E 198.00' (R & M)

TRACT B

